

Suction power will not decrease during extended use or suction of highly viscous fumes caused by laser marking, which typically cause filter clogging.

Product structure and features

Primary filter

■ Uses a cassette filter incorporating zeolite (combined filter and fume adsorbent substance).

[Patent and utility model acquired]

Dust removal function [Vibration type]

When the device stops after cumulative operating time exceeds one hour, the shaker arm automatically vibrates the back of the filter. This causes the primary layer of the filter to peel off/drop off, and returns the filter to its initial condition.

If you need to use the high speed automatic shaker function before an hour has elapsed, the shaker can be manually operated via the panel.

(Primary filter section image)
Shaker arm

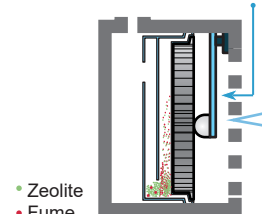

With high speed automatic shaking function

We have accelerated the shaking process after the device switches off to 20 seconds (previously lasted 55 seconds). This has improved operational efficiency and enhanced dust removal performance.

*Compared with our existing products

Easily removable flange

The size of the flange at the outflowport can be changed with a single touch.

Note: Please set the diameter of the outflow flange to be wider than the suction flange.

Secondary filter

Protects electric parts from dust.

Exhaust filter

Equipped with standard HEPA filter.

Complies with clean class 100,000 - 10,000. Collection efficiency is 99.97% or larger for particulates of 0.3 μ.

Activated carbon cassette

Odor-absorbing cassette type. Easy to replace.

Blower

Blower suction pressure automatically increases according to the load of the primary filter.

Suction power is not affected by accumulated loads.

Easily detachable flange type (sold separately)

Size	Type
φ38	FRJ-D-38-35-108
φ50	FRJ-D-50-35-108
φ65	FRJ-D-65-35-108

Note: Please set the diameter of the outflow flange to be wider than the suction flange.

Filter type

Model	Primary filter	Secondary filter	Exhaust filter	Activated carbon filter (Activated carbon amount approx. 3kg)
CBA-1000AT3-HC-DSA-V1	HDF-3535-120-ZEO	CHF-2030-50	HEP-3220-69	ACC-3220-100

List of specifications

Model	Output	Voltage	Frequency	Rated current	Maximum air flow *1*2	Maximum static pressure	Noise level *3	Suction port (hose) size	Suction port sold separately (size can be changed)	
CBA-1000AT3-HC-DSA-V1	500W	100V <small>single phase</small>	50/60	7.8A	3.2 m³/min	9.3-9.5kPa	54-59dB	φ75	φ65・φ50・φ38	
	To be used with 200-240V	CE compliant	Panel	Power cable	Dust removal function	Remote control feature	Suitable for use in clean rooms	Primary filter capacity *4	Mass	Main body dimensions (D×W×H)
	○	○	AT3	3m	Vibration type	○	○	1.5L	32.5ka	405×386×512mm

*1Maximum air volume: 2.7 - 2.9 m³/min when zeolite is deposited.

*22.5 m³/min (CBA-1000AT3-HC-DSA-V1-T) for voltage 200 V voltage only.

*3 Measurements obtained in Scale A (dBA) from a randomly selected position at a distance of 1m using a unit with a hose connected to its suction port.

*4 Because the device uses zeolite, the primary filter capacity will differ from the dust collection capacity.

Note: Contents may change without notice.

Features

Cassette type deodorizing filter

Uses a cassette filter incorporating zeolite (combined filter and fume adsorbent substance). Zeolite is scattered by sucked in air and instantaneously laminated onto the filter surface, to prevent the adhesion of fumes to the filter surface.

[Patent and utility model acquired]

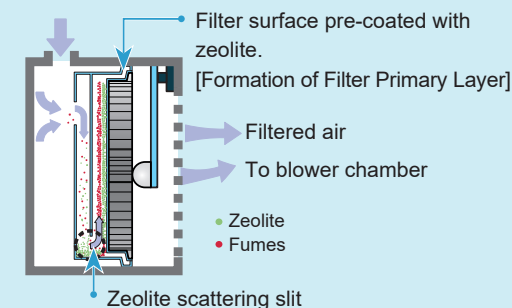

Control panel

AT3 Panel

See pages 8-9 for more details.

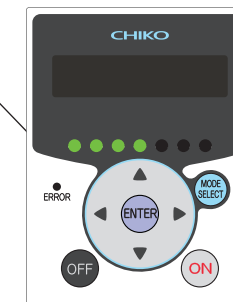

Remote control feature included (for remote operation)

■ Remote cable (sold separately/model: Using MT-173-8 (3 m)) enables remote operation of peripheral equipment.



Motor cable receiving port on main body

1. Operation input signal
2. Operation pressure signal (DC1-5V)
3. Filter clogging signal
4. Remote-control operation switching input signal
5. Operating signal
6. Abnormality signal
7. Change of operating level input signal (DC0-5V)
8. Gnd

- Operation ON/OFF
- Change capacity level (air volume)

List of applications

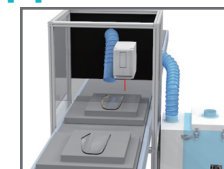

Removal of dust during headlight production

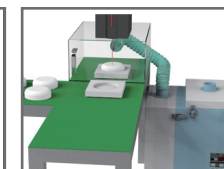

Removal of dust when manually marking duracon

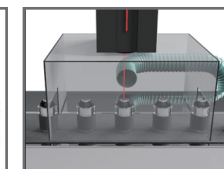

Removal of dust when laser processing bearings

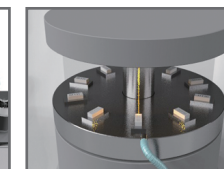

Removal of dust when marking resin connector

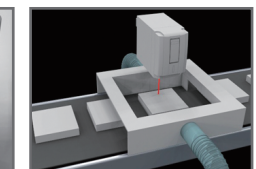

Removal of dust from silicon isolator

Dimensions

CBA-1000AT3-HC-DSA-V1

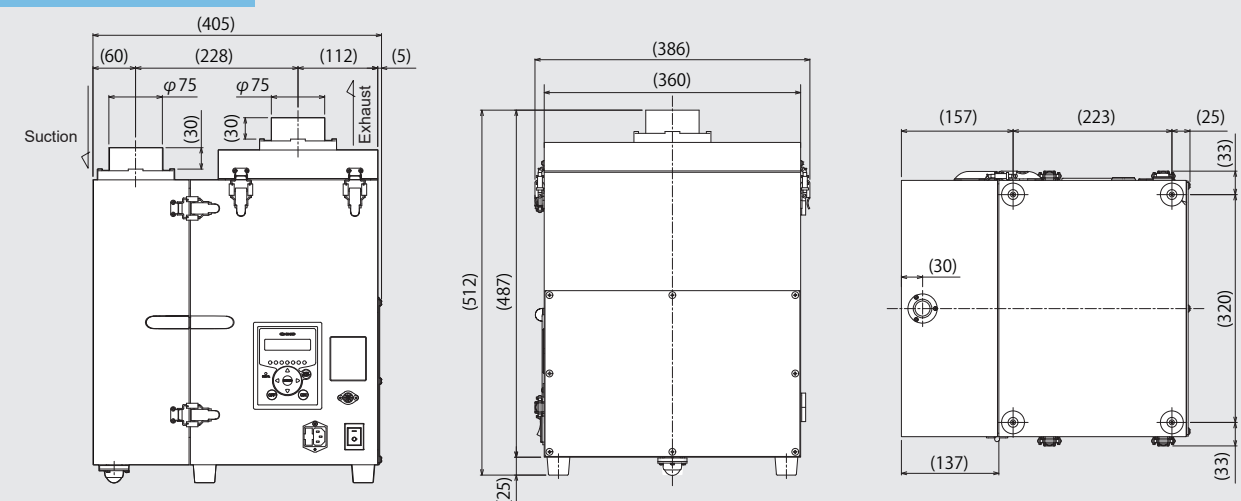

Note: Contents may change without notice.